

Ribbed Bow-Tie Series Knob **NEW!**

1-3/8" (35 mm) Diameter x 1-9/16" (40 mm) Stand-off from Door Surface

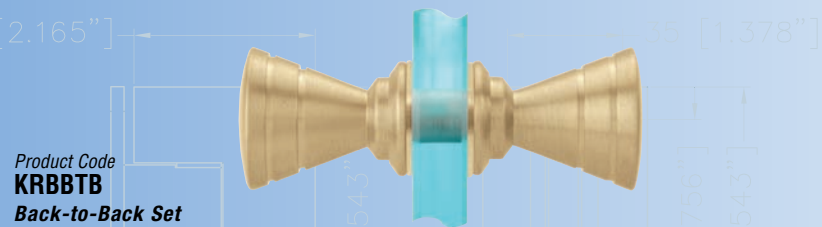

- Solid Brass Thru-Glass Knobs
- Available Back-to-Back Mounting Style
- Designed for 3/16" to 1/2" (5 to 12 mm) Glass
- Requires 3/8" or 1/2" (10 or 12 mm) Diameter Hole for Installation

AVAILABLE IN ALL FINISHES, See Page 3

Flair Series Knob **NEW!**

1-3/16" (30 mm) Diameter x 1-1/16" (27 mm) Stand-off from Door Surface

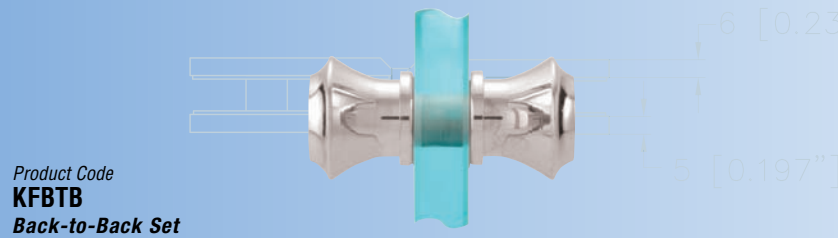

- Solid Brass Thru-Glass Knobs
- Available in Back-to-Back Mounting Style
- Designed for 3/16" to 1/2" (5 to 12 mm) Glass
- Requires 3/8" or 1/2" (10 or 12 mm) Diameter Hole for Installation

AVAILABLE IN ALL FINISHES, See Page 3

Euro Series Knob **NEW!**

1-3/4" (45 mm) Diameter x 1-5/16" (33 mm) Stand-off from Door Surface

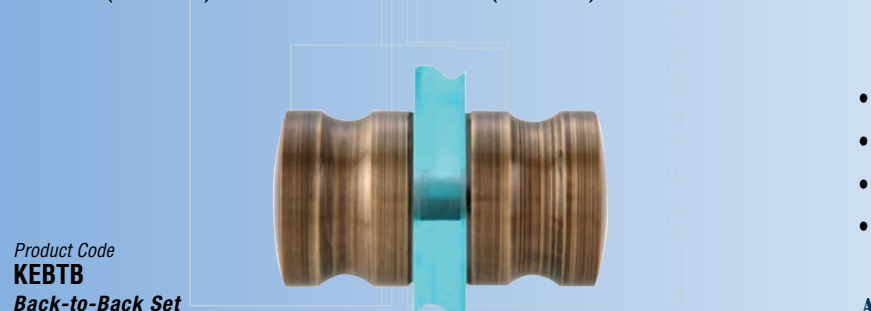

- Solid Brass Thru-Glass Knobs
- Available in Back-to-Back Mounting Style
- Designed for 3/16" to 1/2" (5 to 12 mm) Glass
- Requires 3/8" or 1/2" (10 or 12 mm) Diameter Hole for Installation

AVAILABLE IN ALL FINISHES, See Page 3

Note: Complete the above product codes by adding the desired finish code to the end.

Contemporary Series Knobs

1-3/16" (30 mm) Diameter x 1-3/16" (30 mm) Stand-off from Door Surface.
End Cap for Single Mount Knob Protrudes 1/4" (6 mm) from Door Surface

NEW!

- Solid Brass Thru-Glass Knobs
- Available in Single Mount or Back-to-Back Mounting Styles
- Designed for 3/16" to 1/2" (5 to 12 mm) Glass
- Requires 3/8" or 1/2" (10 or 12 mm) Diameter Hole for Installation

AVAILABLE IN ALL FINISHES, See Page 3



Product Code
KCYBTB
Back-to-Back Set

Product Code
KCYSM
Single Mount

Junior Contemporary Series Knob

1" (25 mm) Diameter x 1-3/16" (30 mm) Stand-off from Door Surface

NEW!

- Solid Brass Thru-Glass Knobs
- Available in Back-to-Back Mounting Style
- Designed for 3/16" to 1/2" (5 to 12 mm) Glass
- Requires 3/8" or 1/2" (10 or 12 mm) Diameter Hole for Installation

AVAILABLE IN ALL FINISHES, See Page 3

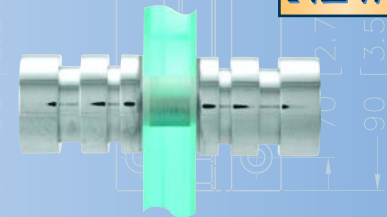

Product Code
KJCBTB
Back-to-Back Set

Crescent Series Knob

1" (25 mm) Diameter x 1-1/8" (29 mm) Stand-off from Door Surface

NEW!

- Solid Brass Thru-Glass Knobs
- Available in Back-to-Back Mounting Style
- Designed for 3/16" to 1/2" (5 to 12 mm) Glass
- Requires 3/8" or 1/2" (10 or 12 mm) Diameter Hole for Installation

AVAILABLE IN ALL FINISHES, See Page 3

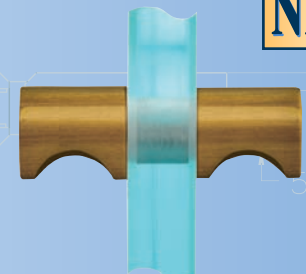

Product Code
KCTBTB
Back-to-Back Set

Mini Bulb Series Knob

3/4" (19 mm) Diameter x 1" (25 mm) Stand-off from Door Surface.
End Cap Protrudes 1/8" (3.2 mm) from Door Surface

NEW!

- Solid Brass Thru-Glass Knobs
- Available in Single Mount Style
- Designed for 3/16" to 1/2" (5 to 12 mm) Glass
- Requires 3/8" or 1/2" (10 or 12 mm) Diameter Hole for Installation

AVAILABLE IN ALL FINISHES, See Page 3

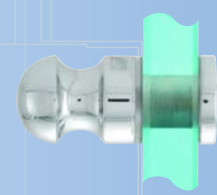

Product Code
KMBSM
Single Mount

*Excellent Choice
for Sliding and
Cabinet Doors!*

Note: Complete the above product codes by adding the desired finish code to the end.

Standard Series Knobs

**3/4" (19 mm) Diameter x 1-1/4" (32 mm)
Stand-Off from Door Surface**

**Designed for Use in Sliding or Swinging
Shower Door Applications**

- Solid Brass Thru-Glass Knobs
- Available in Single Mount or Back-to-Back Mounting Styles
- Designed for 3/16" to 1/2" (5 to 12 mm) Glass
- Requires 3/8" or 1/2" (10 or 12 mm) Diameter Hole for Installation

AVAILABLE IN ALL FINISHES, See Page 3

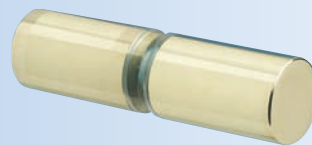

Product Code
KBTB
Back-to-Back Set



Product Code
KSM
Single Mount



Standard Knob
shown attached to a
Single Mount Towel Bar

Cushion Series Knobs

**3/4" (19 mm) Diameter x 1-1/4" (32 mm)
Stand-Off from Door Surface**

**With Cushion to Reduce Impact in Sliding Shower
Door Applications**

- Solid Brass Thru-Glass Knobs
- Available in Single Mount or Back-to-Back Mounting Styles
- Designed for 3/16" to 1/2" (5 to 12 mm) Glass
- Requires 3/8" or 1/2" (10 or 12 mm) Diameter Hole for Installation

AVAILABLE IN ALL FINISHES, See Page 3



Product Code
KCBTB
Back-to-Back Set



Product Code
KCSM
Single Mount

Crystal Knobs

- Surface Mount with U.V. Adhesive
- No Hole Drilling Required

Contemporary Style



Product Code **KCRYC**

1-15/16"
(49 mm)
Diameter

x
2-1/16"
(52 mm)

**Stand-off from
Door Surface**

Traditional Style



Product Code **KCRYT**

1-15/16"
(49 mm)
Diameter

x
1-13/16"
(46 mm)

**Stand-off from
Door Surface**



**50 ml
Ultraviolet
Adhesive**

Product Code	Description
UVA-50	Ultraviolet Adhesive-50 ml
UV-CD	Adhesive Cleaner/Conditioner
UV-BPL	Battery Operated Ultraviolet Light

Note: Complete the above product codes by adding the desired finish code to the end.

Colonial Series Knobs

1" (25 mm) Diameter x 2-1/8" (54 mm) Stand-Off from Door Surface

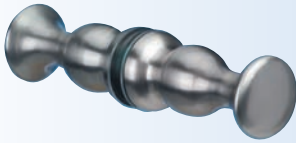

Product Code
K-COLBTB
Back-to-Back Set



Product Code
K-COLSM
Single Mount

Suggestion:
Excellent for use
as a Robe Hook

- Solid Brass Thru-Glass Knobs
- Available in Single Mount or Back-to-Back Mounting Styles
- Designed for 3/16" to 1/2" (5 to 12 mm) Glass
- Requires 3/8" or 1/2" (10 or 12 mm) Diameter Hole for Installation

AVAILABLE IN ALL FINISHES, See Page 3

Deluxe Series Knobs

1-3/16" (30 mm) Diameter x 1-3/8" (35 mm) Stand-Off from Door Surface



Product Code
KDBTB
Back-to-Back Set



Product Code
KDSM
Single Mount

- Solid Brass Thru-Glass Knobs
- Available in Single Mount or Back-to-Back Mounting Styles
- Designed for 3/16" to 1/2" (5 to 12 mm) Glass
- Requires 3/8" or 1/2" (10 or 12 mm) Diameter Hole for Installation

AVAILABLE IN ALL FINISHES, See Page 3

Traditional Series Knobs

1-9/16" (40 mm) Diameter x 1-3/16" (30 mm) Stand-Off from Door Surface



Product Code
KTBTB
Back-to-Back Set



Product Code
KTSM
Single Mount

- Solid Brass Thru-Glass Knobs
- Available in Single Mount or Back-to-Back Mounting Styles
- Designed for 3/16" to 1/2" (5 to 12 mm) Glass
- Requires 3/8" or 1/2" (10 or 12 mm) Diameter Hole for Installation

AVAILABLE IN ALL FINISHES, See Page 3

Note: Complete the above product codes by adding the desired finish code to the end.

Knob Latch

1-3/16" (30 mm) Diameter x 1-1/2" (38 mm) Standoff from Door Surface

- Solid Brass Thru-Glass Knobs
- Available in Back-to-Back Mounting Style
- Designed for 5/16" to 1/2" (8 to 12 mm) Glass
- Requires 7/8" (22 mm) Hole in Glass
- Includes Wall Mounted Tapered Strike and J-Hook for Glass-to-Glass

NEW!



Product Code **KL180**
180 Degree Model With 2-1/2" (63 mm) Throw Extension.
 Shown With J-Hook for Glass-to-Glass Installation. J-Hook Adhered With U.V. Adhesive (see page 44)

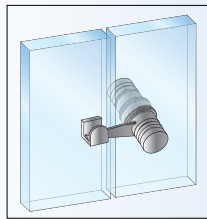

Glass-to-Glass Inside View

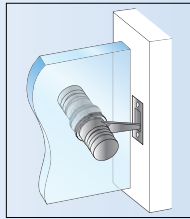

Glass-to-Wall Inside View



Tapered Strike for Glass-to-Wall Installation (Mounting Screws not included)

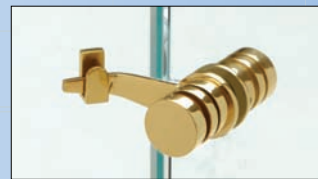

Product Code **KL135**
135 Degree Model With 2" (51 mm) Throw Extension.
 Shown With J-Hook for Glass-to-Glass Installation. J-Hook Adhered With U.V. Adhesive (see page 44)

AVAILABLE IN ALL FINISHES, See Page 3

Swinging Glass Door Lock With Indicator

- Suitable for Swinging Doors from 5/16" to 1/2" (8 to 12 mm) Thick
- Lock Can Be Used Glass-to-Wall or Glass-to-Glass, With Optional Matching Keeper
- Indicator on Exterior Displays Red if Lock is Activated; Blue if Lock is Open
- Includes Wall Mounted Strike Plate, Screws and Anchors, Gaskets and Hex Wrench
- Glass Must Be Notched for Installation

NEW!

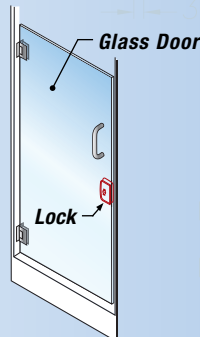

Lock on Single Door Glass-to-Wall

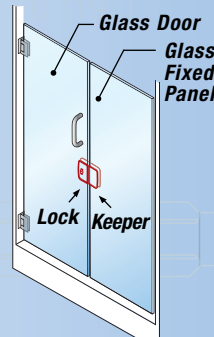

Lock and Keeper on Glass-to-Glass Door

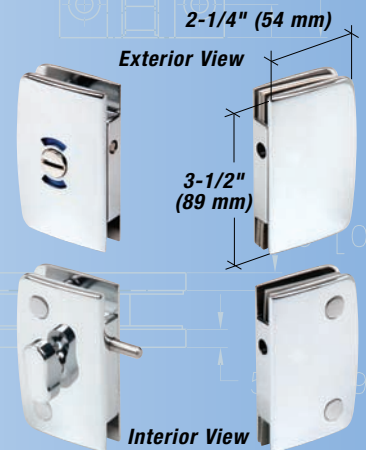

Product Code **L-LSW** Lock

Product Code **L-KSW** Keeper

AVAILABLE IN POLISHED CHROME, POLISHED BRASS, SATIN NICKEL (BRUSHED), OIL RUBBED BRONZE AND ANTIQUE BRASS

Sliding Glass Door Lock With Indicator

NEW!

- Suitable for Sliding Doors from 5/16" to 1/2" (8 to 12 mm) Thick
- Lock Can Be Used Glass-to-Wall or Glass-to-Glass, Inline Panel or Door
- Indicator on Exterior Displays Red if Lock is Activated; Blue if Lock is Open
- Includes Wall Mounted Strike Plate, Screws and Anchors, Gaskets and Hex Wrench
- Glass Must Be Notched for Installation

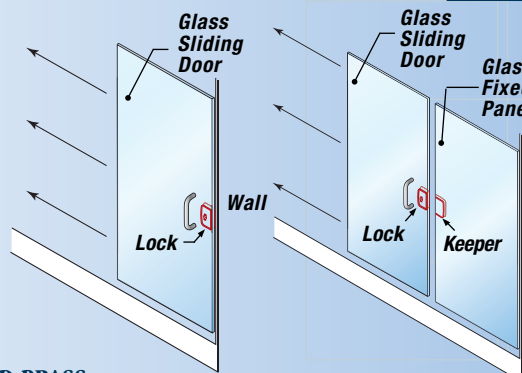

Lock on Single Door Glass-to-Wall

Lock and Keeper on Glass-to-Glass Door

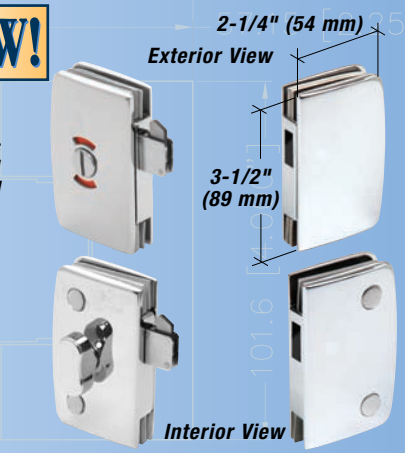

Product Code **L-LSL** Lock

Product Code **L-KSL** Keeper

AVAILABLE IN POLISHED CHROME, POLISHED BRASS, SATIN NICKEL (BRUSHED) AND OIL RUBBED BRONZE

Note: Complete the above product codes by adding the desired finish code to the end.